

Planning Exhibit for Moon Builder, L.L.C. – 123 Elmwood Pl, City of Plainfield, NJ

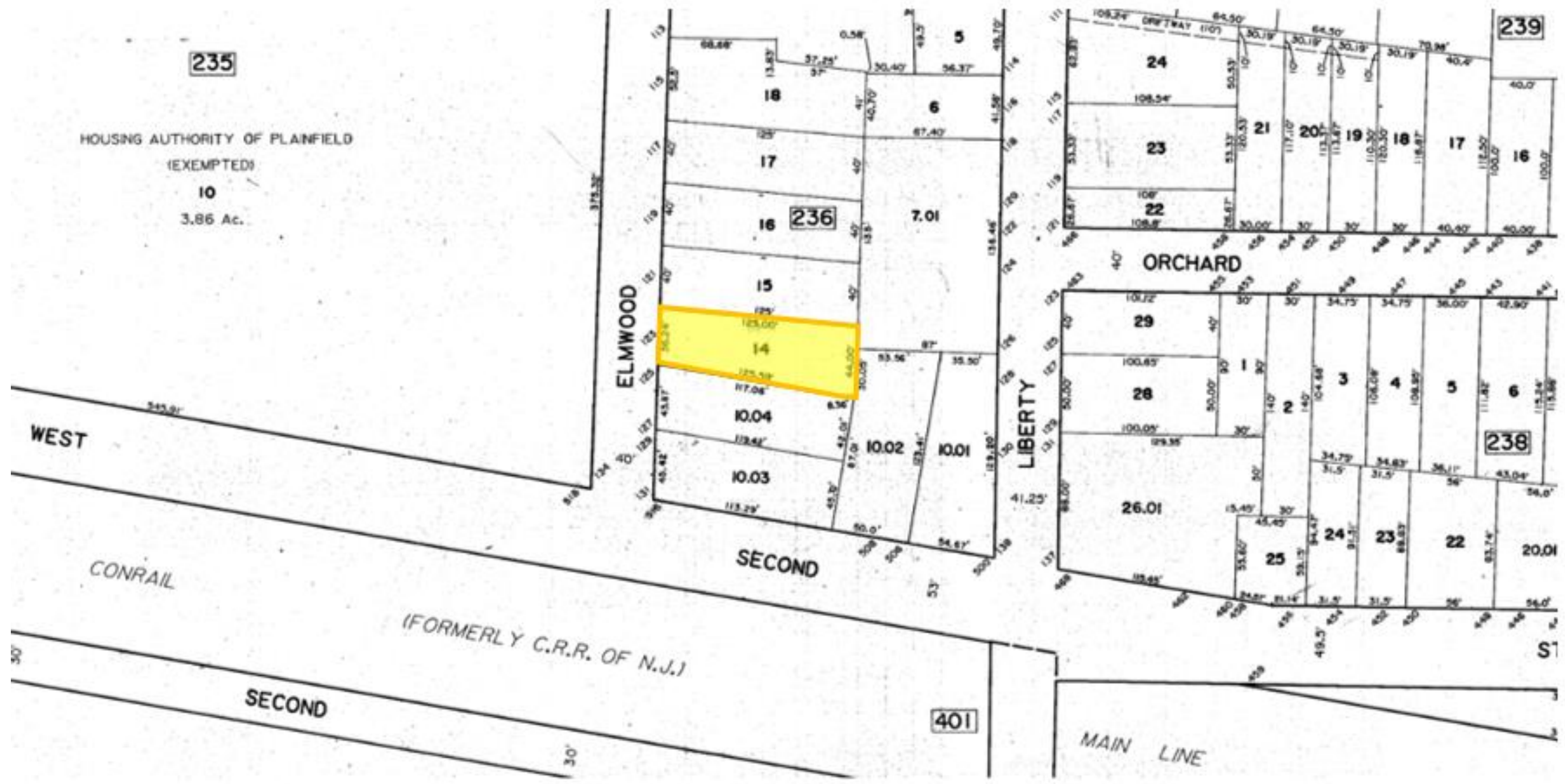

Map 1. Subject property at 123 Elmwood Place, shown approximately in yellow highlight. North ↑. Source: City of Plainfield Tax Assessment Map.

Planning Exhibit for Moon Builder, L.L.C. – 123 Elmwood Pl, City of Plainfield, NJ

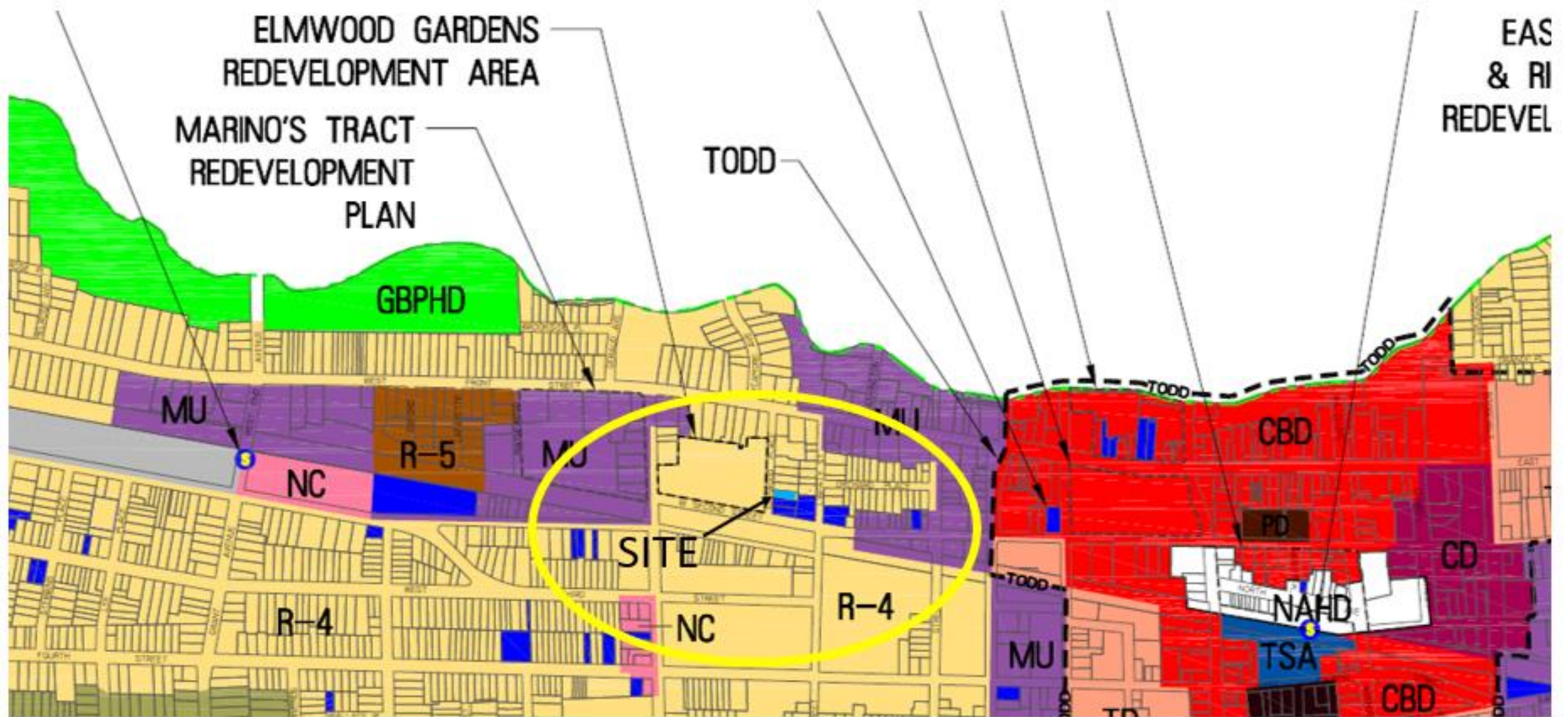

Map 2. Excerpt of City of Plainfield Zoning Map. Subject property shown in light blue highlight. N: ↗.

Planning Exhibit for Moon Builder, L.L.C. – 123 Elmwood Pl, City of Plainfield, NJ



Image 1. Aerial view of subject neighborhood with property at 123 Elmwood Place shown in light blue highlight. N: ↑ .

Planning Exhibit for Moon Builder, L.L.C. – 123 Elmwood Pl, City of Plainfield, NJ



Image 2. View of subject vacant lot at 123 Elmwood Pl, from street, looking northeast.



Image 3. View toward subject vacant lot from rear, Lot 10.03, Block 236.



Image 4. View from Elmwood Place toward two adjacent 2-family homes now under construction to the southeast of subject vacant lot, looking northeast.



Image 5. View of existing adjacent single-family home at 121 Elmwood Place, looking northeast.

Planning Exhibit for Moon Builder, L.L.C. – 123 Elmwood Pl, City of Plainfield, NJ



Image 6. View toward side of 121 Elmwood Pl, looking north from frontage of subject vacant lot.



Image 7. Land use to northeast (rear) of subject vacant lot – two vacant house lots.



Image 8. Land use across Elmwood Place – Elmwood Gardens Redevelopment Area, site of planned multi-family housing.



Image 9. Land use to rear left corner of subject vacant lot – paved parking lot for Mt. Olive Baptist Church use only.

Planning Exhibit for Moon Builder, L.L.C. – 123 Elmwood Pl, City of Plainfield, NJ



Image 10. View from Elmwood Place toward existing 2-family home at 119 Elmwood Place (on left) and single-family dwelling at 121 Elmwood Pl, adjacent to subject site



Image 11. View of subject vacant lot and existing residential structures to each side, from Elmwood Pl.



Image 12. View toward rear of two new two-family homes now under construction to immediate southeast of subject vacant lot. These homes are at 125 and 129 Elmwood Place.



Image 13. View from sidewalk in front of 129 Elmwood Place to perpendicular parking area on west side of Elmwood Place.